



# FV103

## Light Duty Transit Nozzle

### Instruction Manual

#### **⚠ WARNING**

Failure to follow these instructions or to properly install and maintain this equipment could result in gas leakage, fire or explosion causing property damage and personal injury or death.

Oasis products must be installed, operated and maintained by trained and competent personnel in accordance with all applicable local codes, rules and regulations in addition to the Oasis Instructions.

Oasis Engineering Ltd. will not be held liable in such circumstances where installation, operation and maintenance procedures were performed by incompetent personnel resulting in improper assembly, unsafe operation, equipment damage or personal injury.

Oasis recommends that all service technicians should watch the Product Servicing Video before attempting to service this part.



Servicing Video

Oasis Engineering Ltd  
129 Birch Avenue, Tauranga, New Zealand.  
T: +64 7 928 3808  
E: [info@oasisNGV.com](mailto:info@oasisNGV.com)  
W: [www.OasisNGV.com](http://www.OasisNGV.com)



Instruction Manual

## Warning!

High pressure gas and gas equipment can cause serious harm to both infrastructure and personnel if safety precautions are not followed.

Oasis recommends considering the use of the following PPE when working with high pressure along with any other site specific health and safety requirements:



Foot Protection



Hearing Protection



Safety Helmets



Hand Protection



Safety Glasses



Ensure the system is clean of debris, vented and isolated before any installation or servicing work is carried out.

## Tools Required

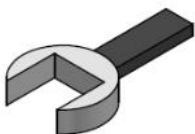

Spanner  
(Wrenches)

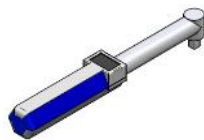

Torque Wrench



Anti Seize Grease  
- Swagelok Silver Goop  
- Omega 99  
- or similar



Thread locker  
Loctite 243 or  
Similar



Bucket of Water



Heat gun

1. Apply thread locker to thread and tighten nozzle adaptor into valve.

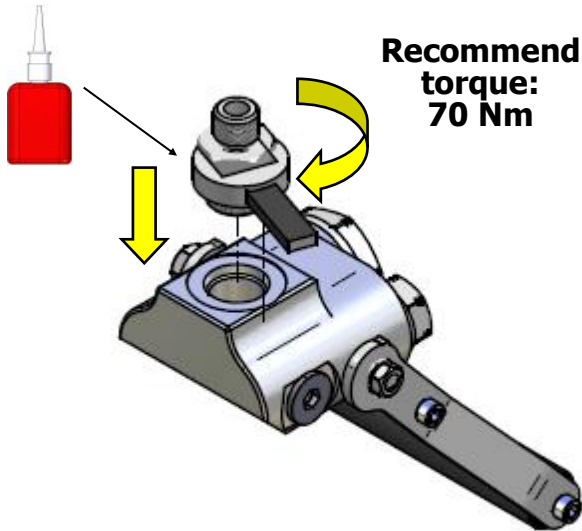

2. Apply thread locker to thread and attach nozzle.

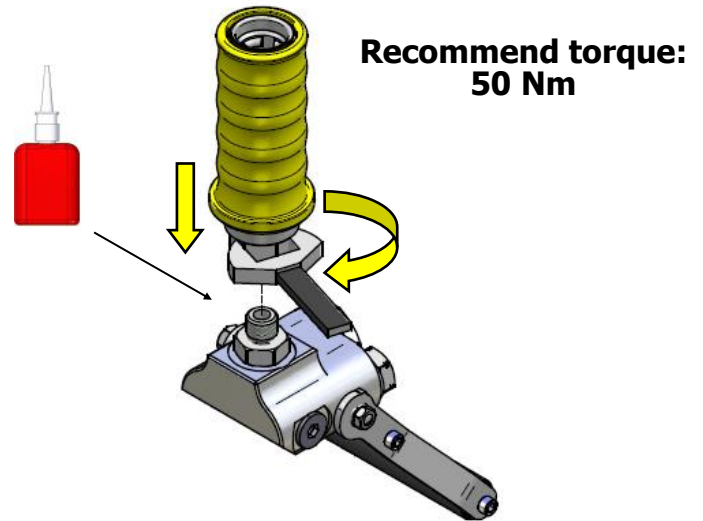

3. Attach vent adaptor as per fitting manufacturers instructions.

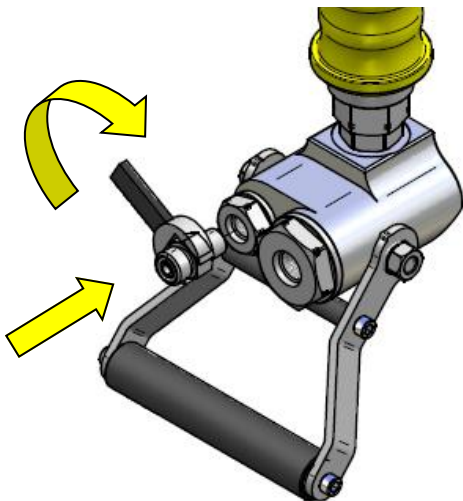

4. Attach main hose adaptor as per fitting manufacturers instructions.

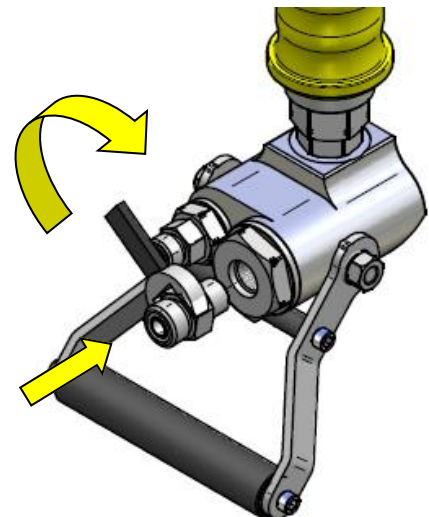

5. Fit hose cover over hose before fitting hoses to valve.

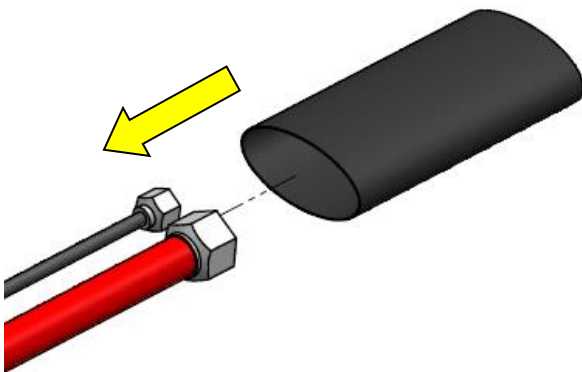

6. Connect vent hose as per manufacturers instructions.

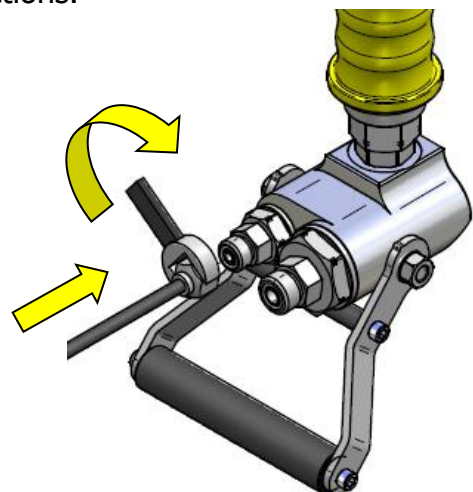

7. Connect fill hose as per manufacturers instructions.

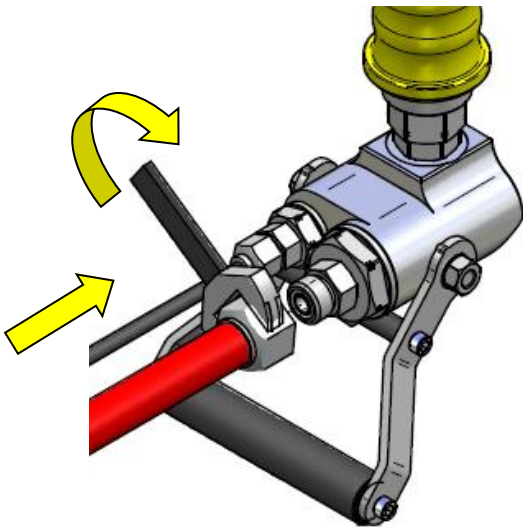

8. Push up hose cover.

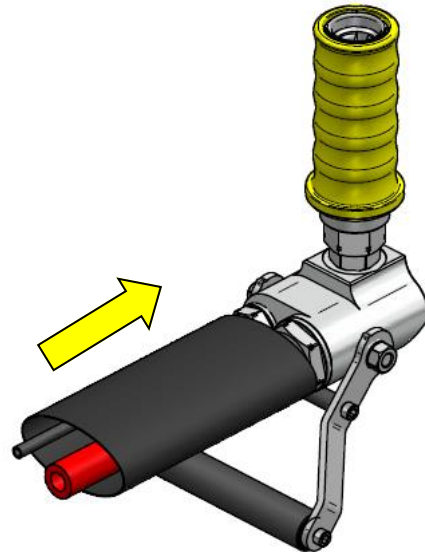

9. Use heat gun to shrink hose cover over hoses.

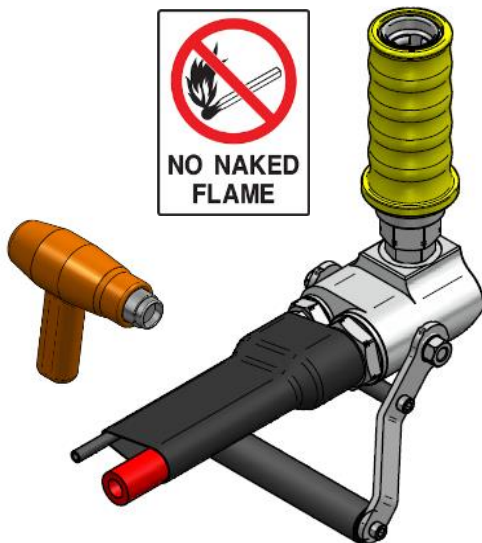

10. Assembly complete.

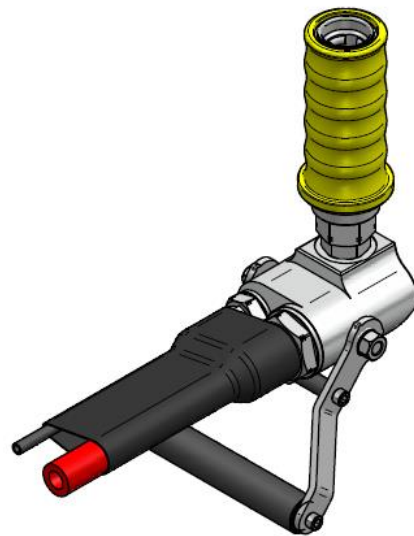

11. Test for leaks before use, place fill valve and nozzle in bucket of water with valve open and look for bubbles. Use snoop or soapy water for unsubmerged connections. Wait 24h before leak test to allow Loctite to dry.

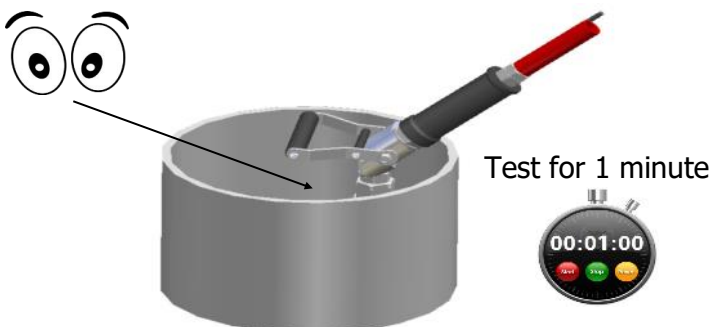

**CAUTION**

When testing the valve, ensure the valve is held securely and opened slowly for the first time after servicing. If any leakage occurs then stop test and do not use nozzle. Contact Oasis for help.

**WARNING**

OASIS NOZZLES SHOULD BE TESTED BEFORE RETURNING TO OPERATION. DO NOT USE IF LEAKAGE OCCURS.



1. Pick up fill valve.

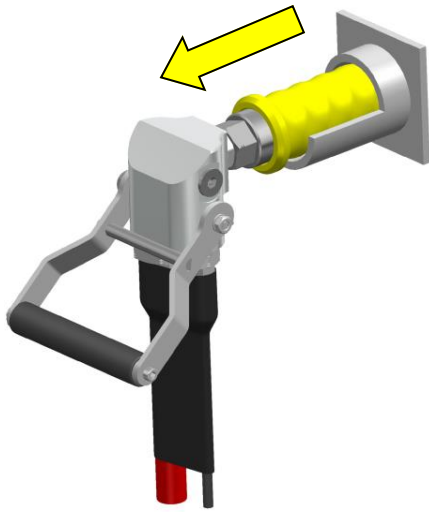

2. Push onto the receptacle.

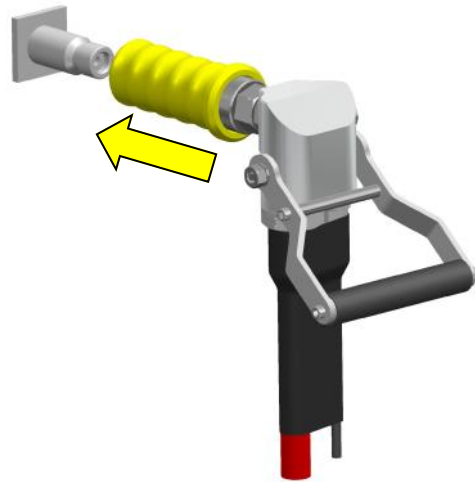

3. The green indication sleeve is visible showing the nozzle is connected.

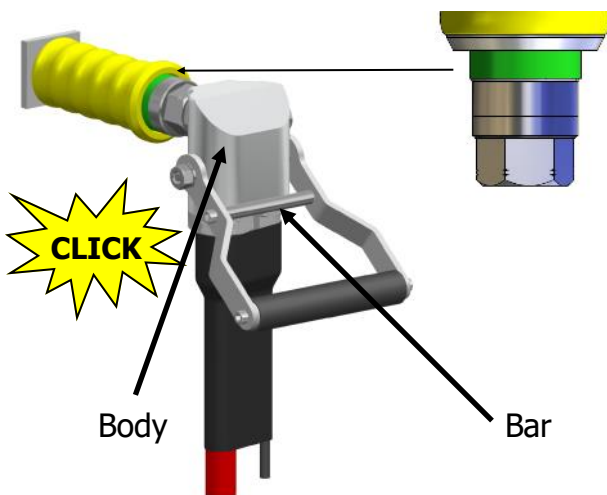

4. Lift up lever in one swift motion to fill.

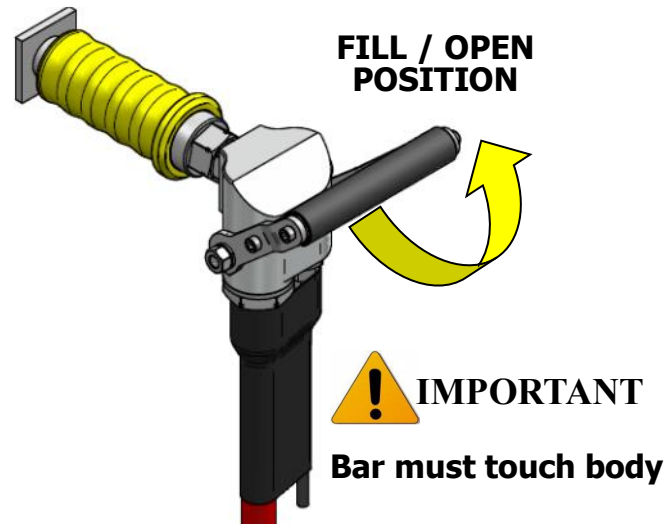

5. When filling is complete, push down to shut off the lever.

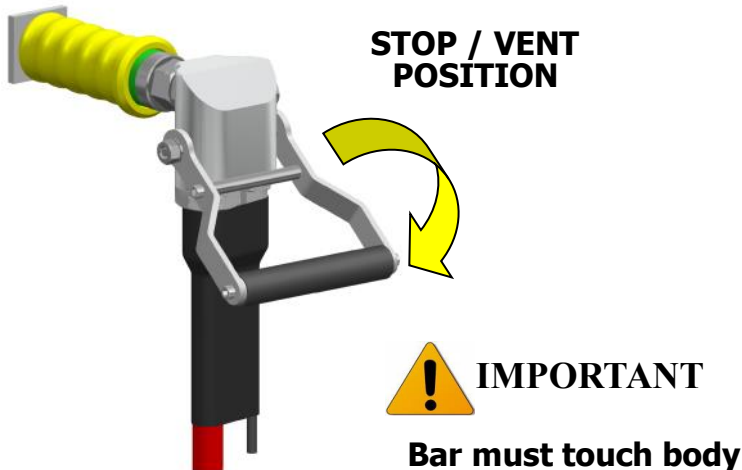

6. Pull nozzle sleeve back to disengage.

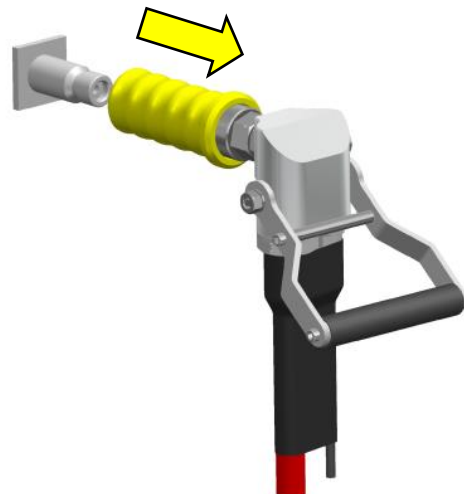

## 7. Hang up fill valve.

Extension fittings are available from Oasis if required.

Part Numbers:  
50mm Extension = NC103-36  
100mm Extension = NC103-37

Contact Oasis for more information

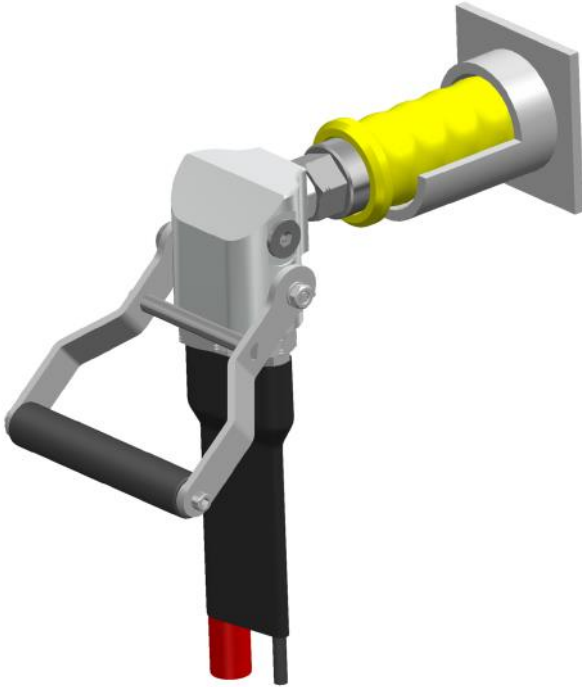

## IMPORTANT

**DO NOT DROP OR LEAVE ON FLOOR**

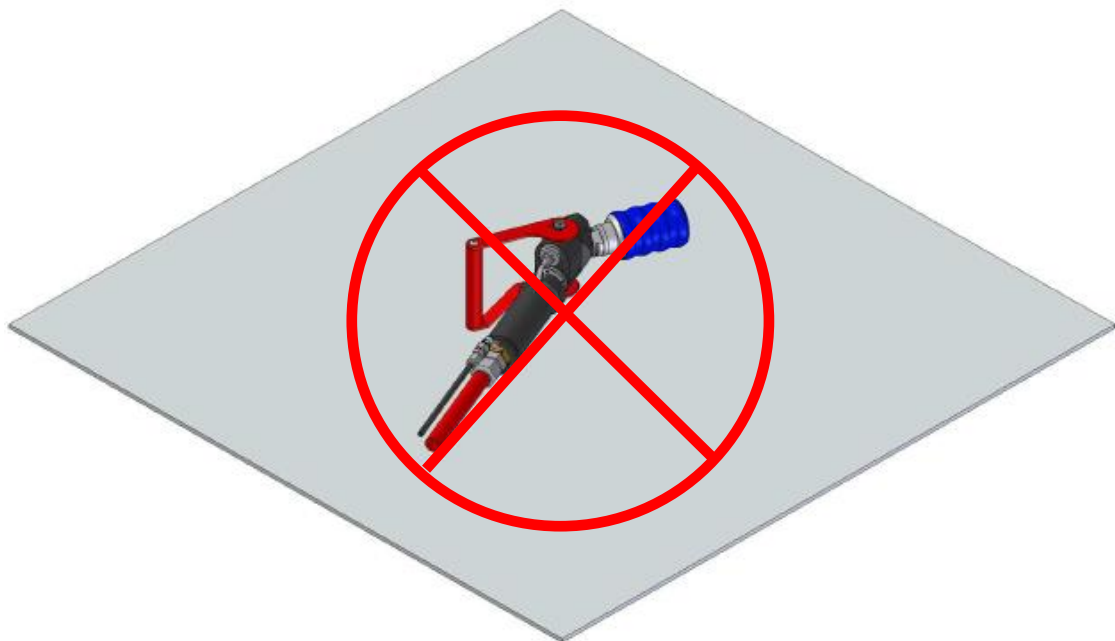

## Service Kit Parts



1 x Vent Ball



2 x Vent Seats



1 x Small gland



2 x Vent seat O-rings



1 x Vent Stem



1 x Fill ball



2 x Fill seats



1 x Big gland



2 x Fill seat O-rings



1 x Fill stem



1 x Vent end cap O-ring



1x Loctite 243



1 x Silicone Grease



1 x Fill end cap O-ring



1 x Blanking Plug



1 x Hose Cover



1 x Handle Sleeve

**The Complete Oasis Seal Kit must be used**

## Tools Required



**Cleaner**  
(Warm Soapy  
Water or Similar)



**Anti Seize Grease**  
(Loctite 771 or  
Similar)

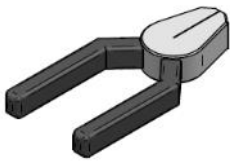

**Pliers**



**Allen Key**  
4mm  
1/4"

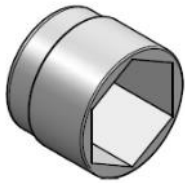

**Sockets**  
- 10mm  
- 13mm  
- 21mm  
- 1 5/16"  
- 1/4" Hex

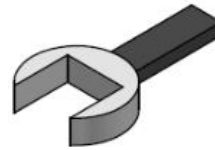

**Spanner**  
(Wrenches)  
- 10mm  
- 13mm  
- 21mm  
- 26mm  
- 1 5/16"

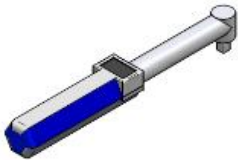

**Torque Wrench**



**Pick Tool**  
Part Number:  
TOOL-PICK  
(Sold separately)



**Heat gun**



**Soft face mallet**



**Thread locker**  
Loctite 243 or  
Similar



1. Isolate the fill valve and vent all pressure from hose.

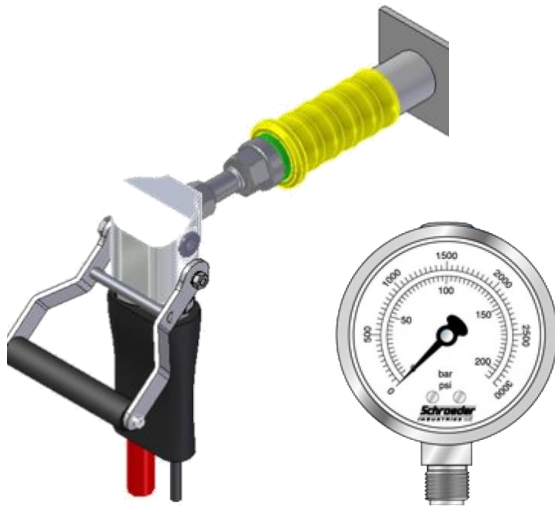

2. Remove nozzle from outlet connection.

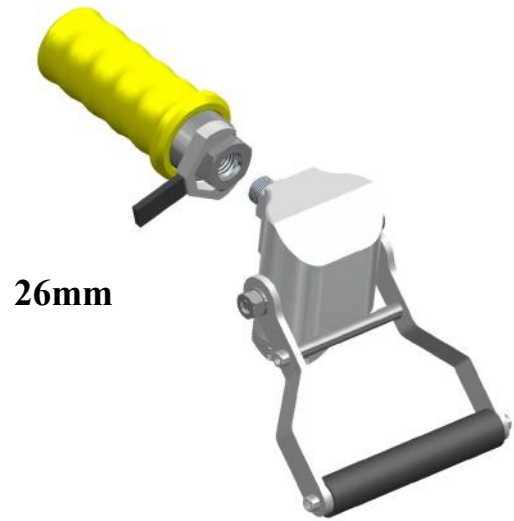

3. Remove outlet connection & discard both O-rings.

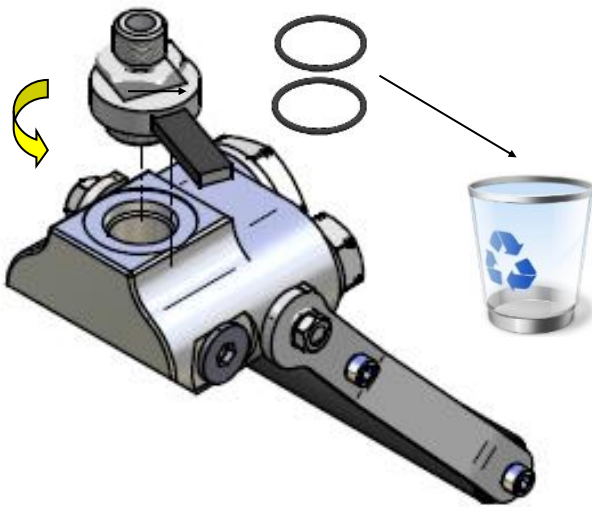

4. Remove vent-side screw, nut and handle.

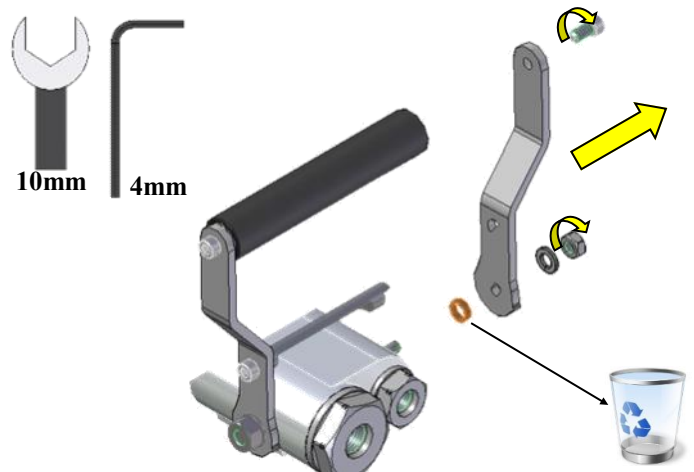

5. Remove fill-side nut & handle assembly.



6. Remove fill cap & discard O-ring.

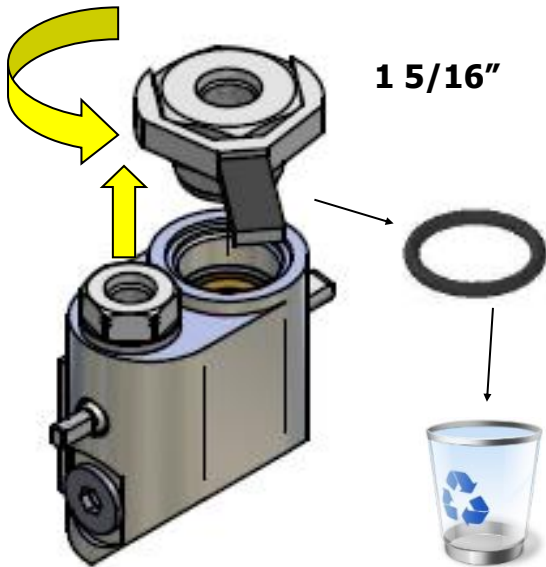

7. Remove 1st fill O-ring, seat and discard both.

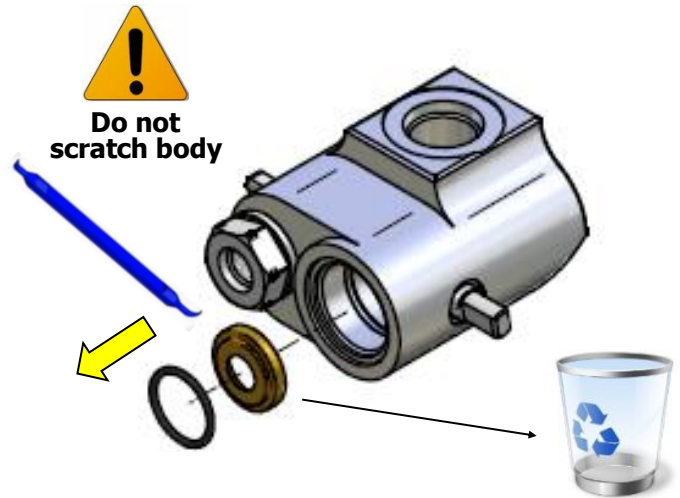

8. Remove fill ball and discard.

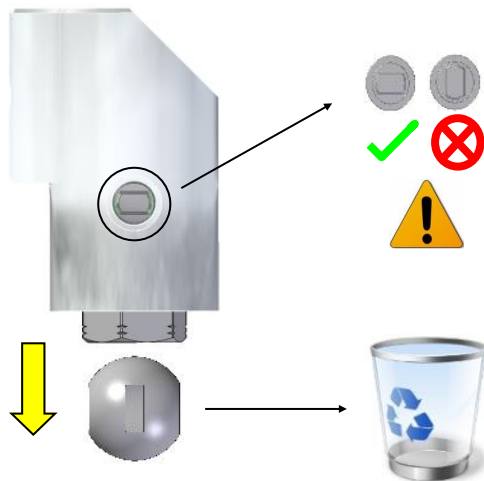

9. Remove fill stem and discard.

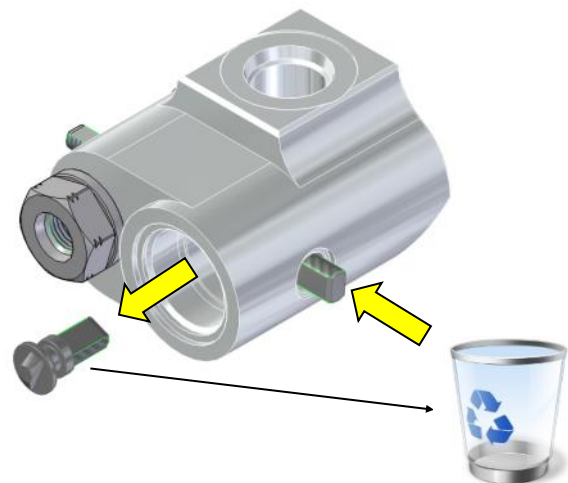

10. Remove 2nd fill seat, O-ring and discard both.

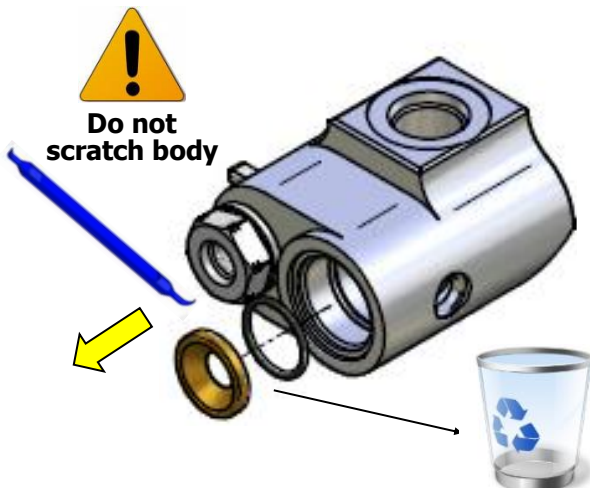

11. Remove vent cap and discard O-ring.

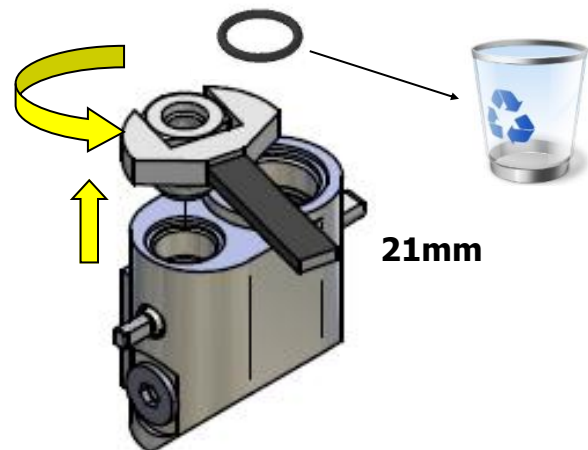

12. Remove 1st vent O-ring, seat and discard both.

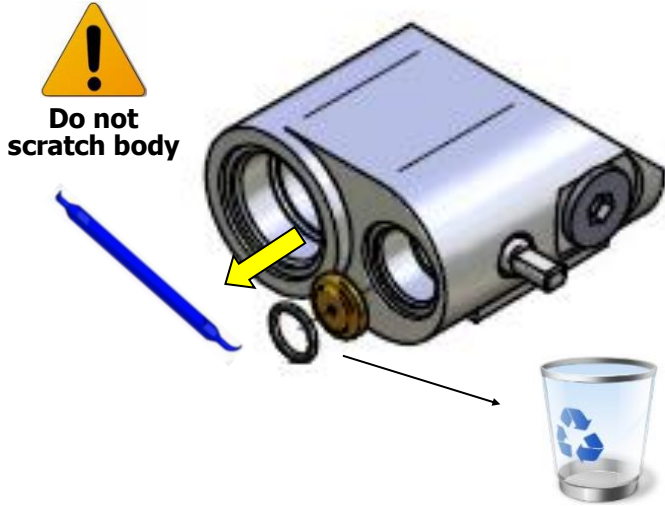

13. Remove vent ball and discard.

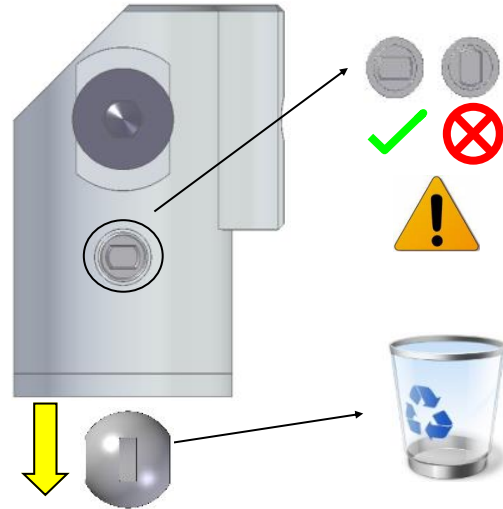

14. Remove vent stem and discard.



15. Discard vent seat, O-ring and discard both.

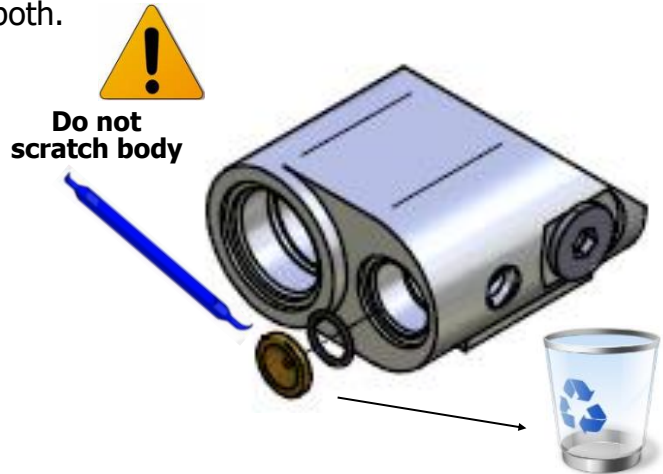

16. Remove blank and discard O-ring.

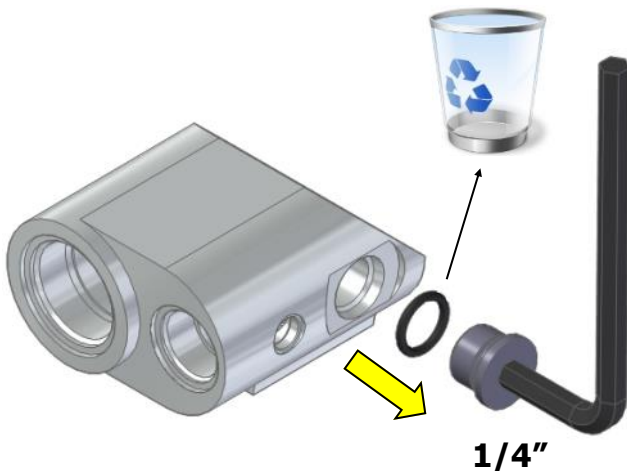



17. Clean all parts and check for damage.

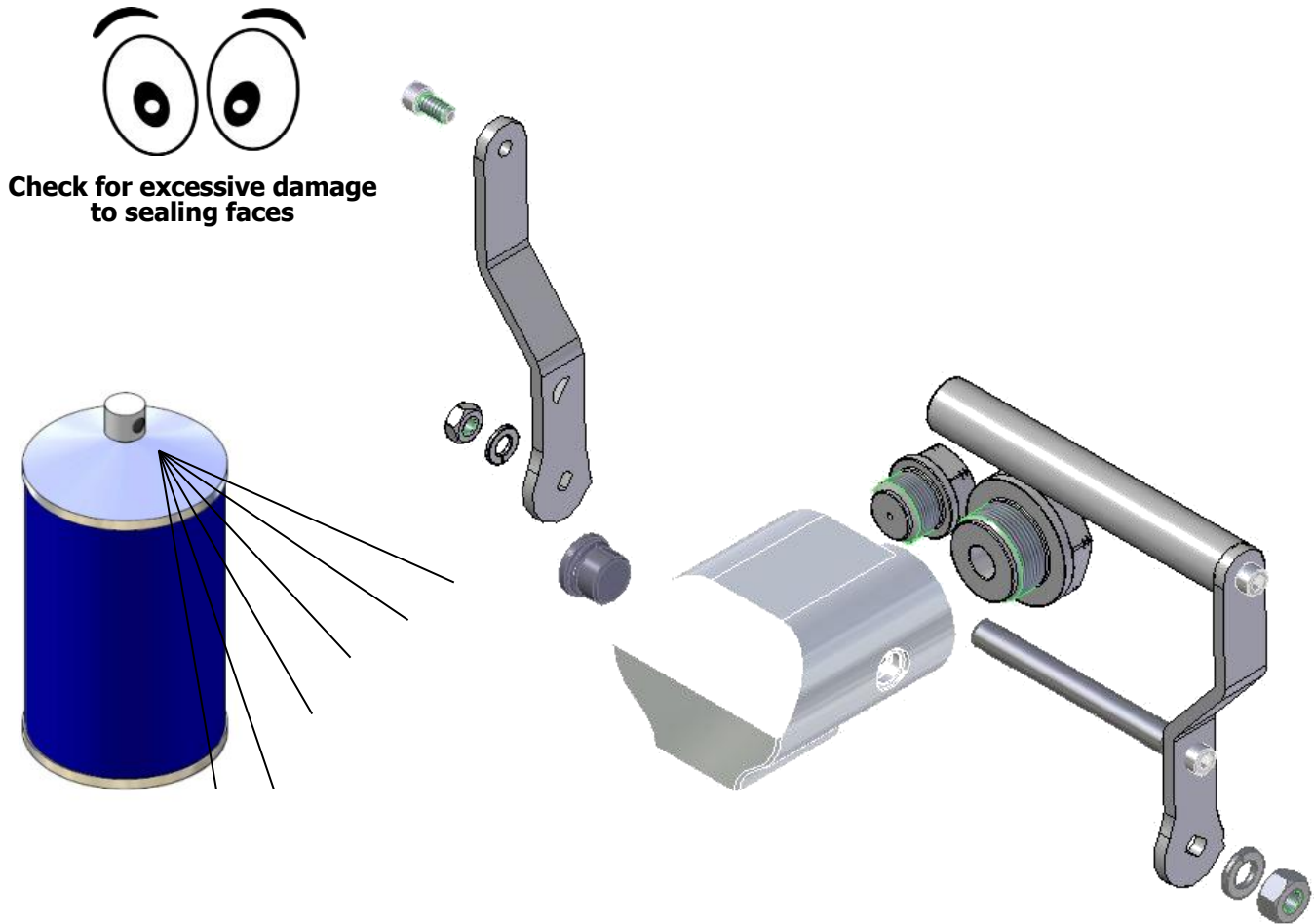



1. Silicone grease O-ring and install onto blank, then apply anti seize to threads after.

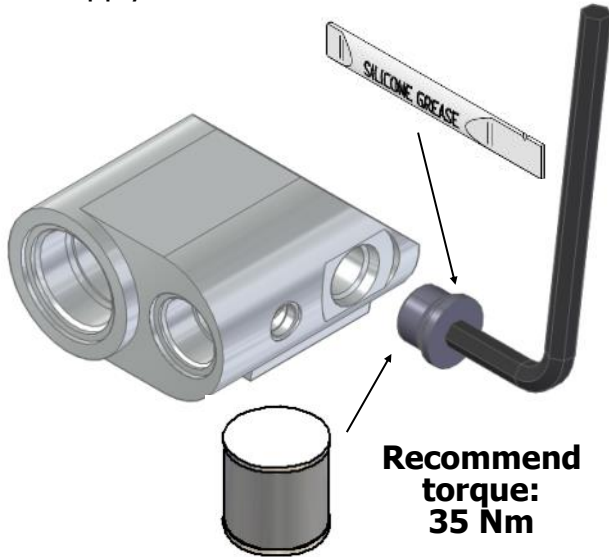

2. Grease stem O-ring and install through vent outlet and out stem hole.



3. Install vent seat and silicone greased O-ring into vent outlet.

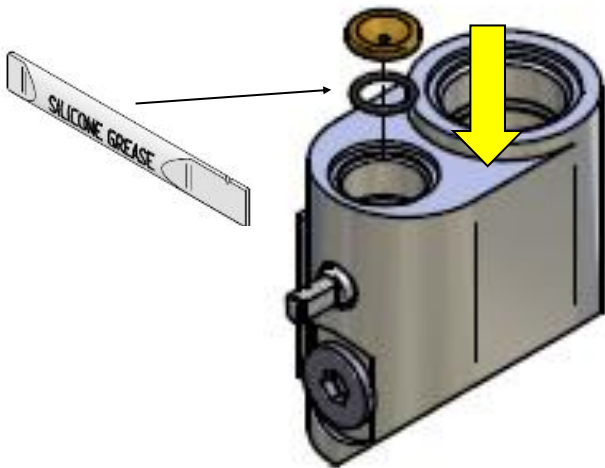

4. Line up grooves and install vent ball.

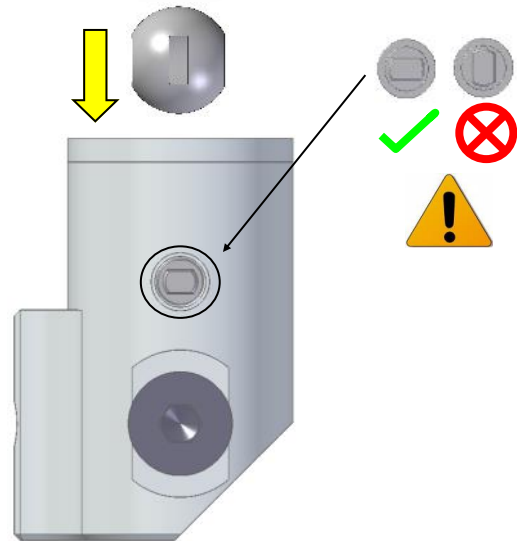

5. Insert second vent seat and silicone greased O-ring into vent outlet.

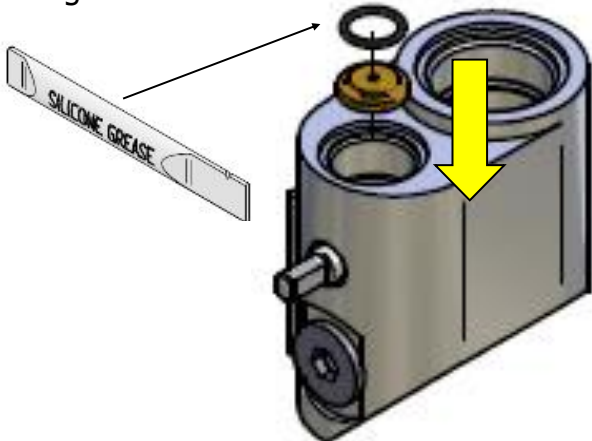

6. Silicone grease O-ring and install on end cap. Apply anti seize grease to threads after.

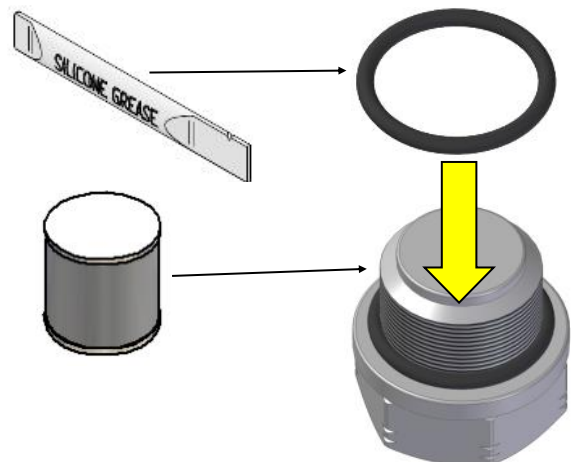

7. Screw in vent end cap & torque.

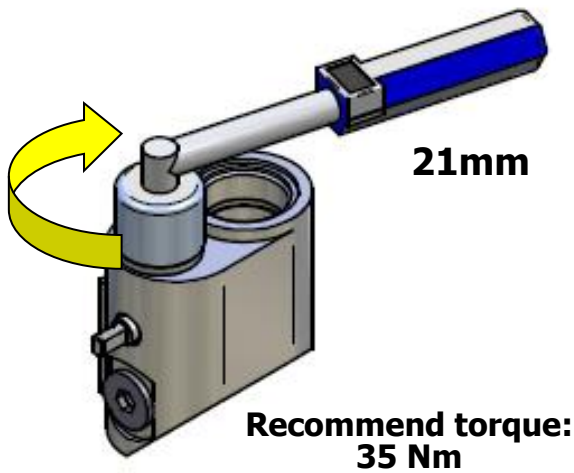

9. Grease stem O-ring and install through main inlet and out stem hole.

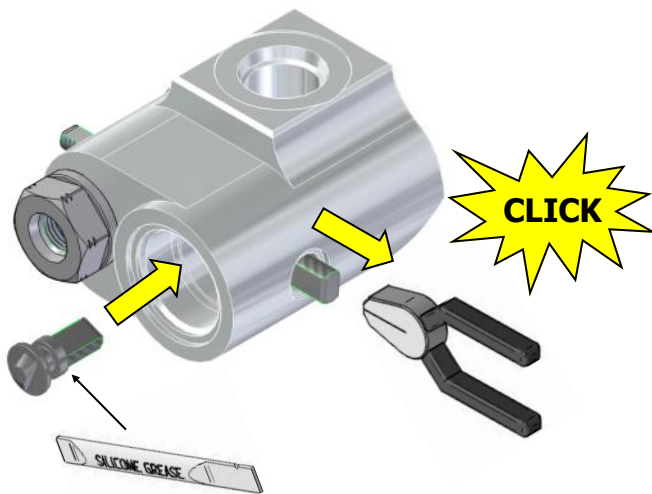

11. Insert seat and silicone greased O-ring into main inlet.

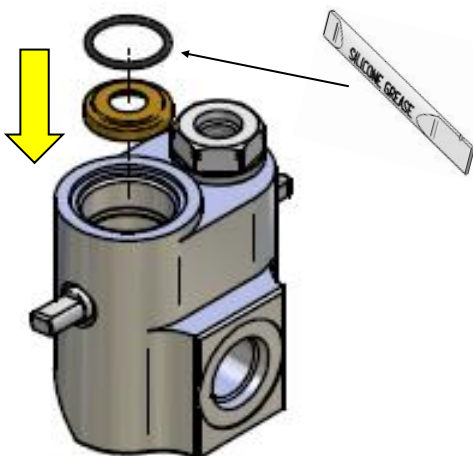

8. Insert silicone greased O-ring and seat into main inlet.

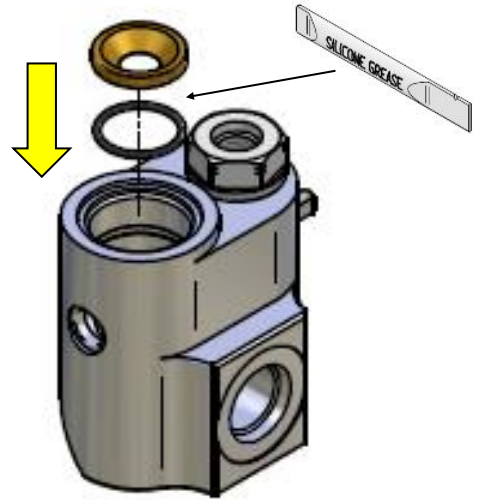

10. Line up grooves and install fill ball.

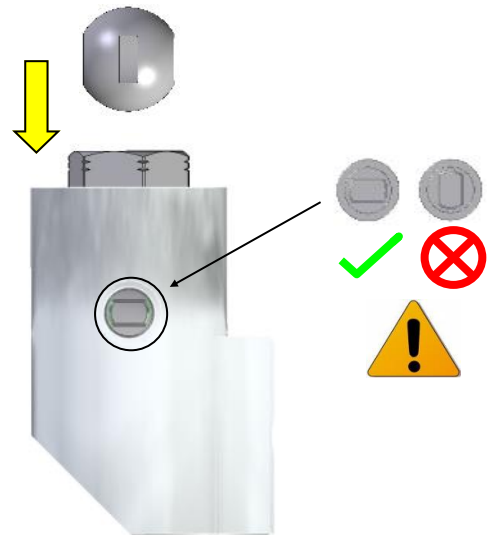

12. Silicone grease O-ring and install on end cap. Apply anti seize grease to threads after.

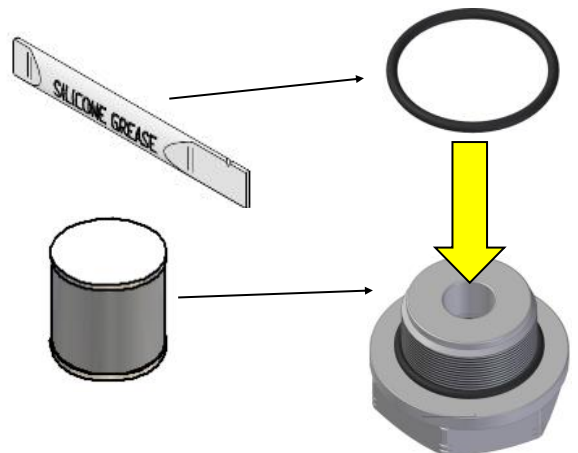

13. Screw in end cap & torque.

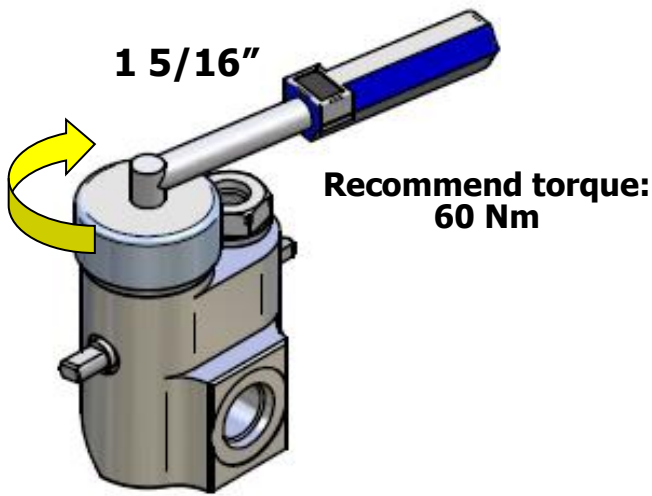

14. Align, place & tighten fill-side handle assembly.

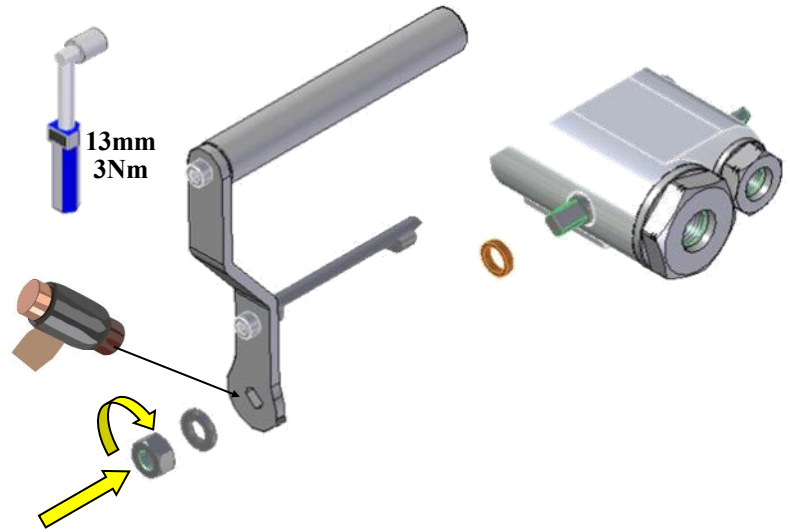

15. Align, place & tighten vent-side handle & handle sleeve.

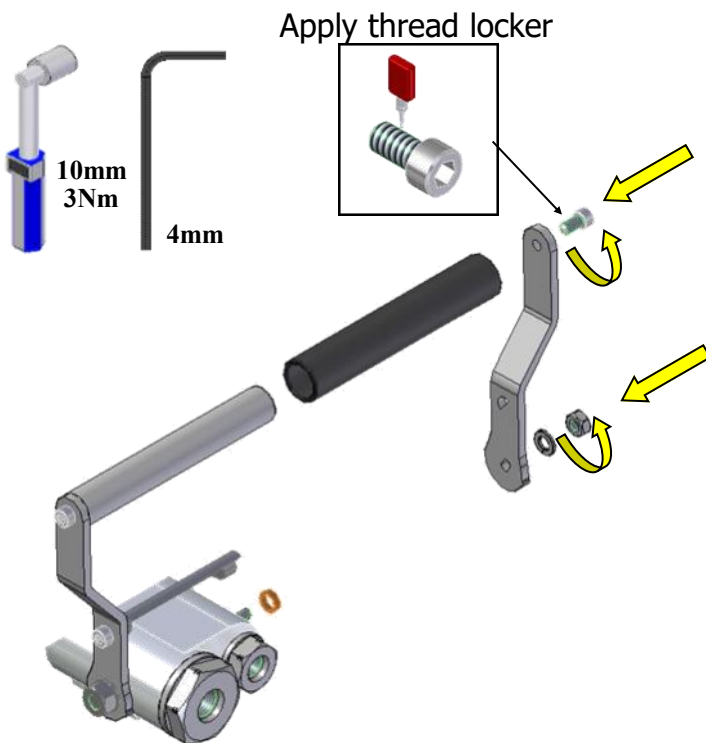

16. Open and close fill valve 5 times.

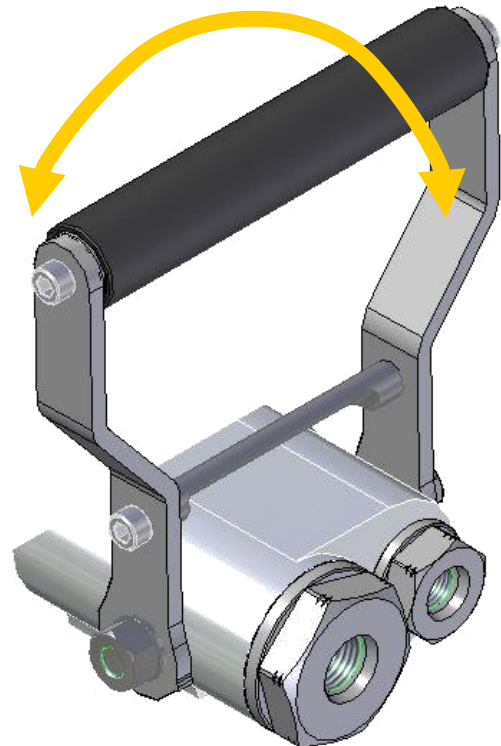

17. Light duty fill valve assembly is complete.

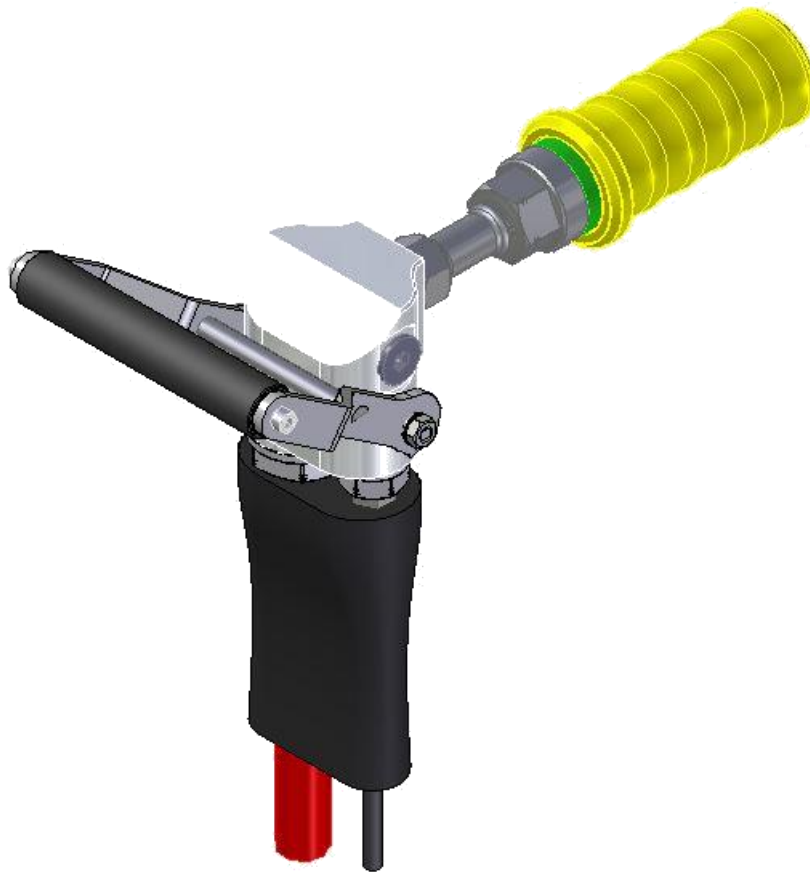

**Follow the installation and operation  
instructions on page 3-6 to re-install  
and leak test on first use.**



1. Isolate the fill valve and remove the existing handle components.

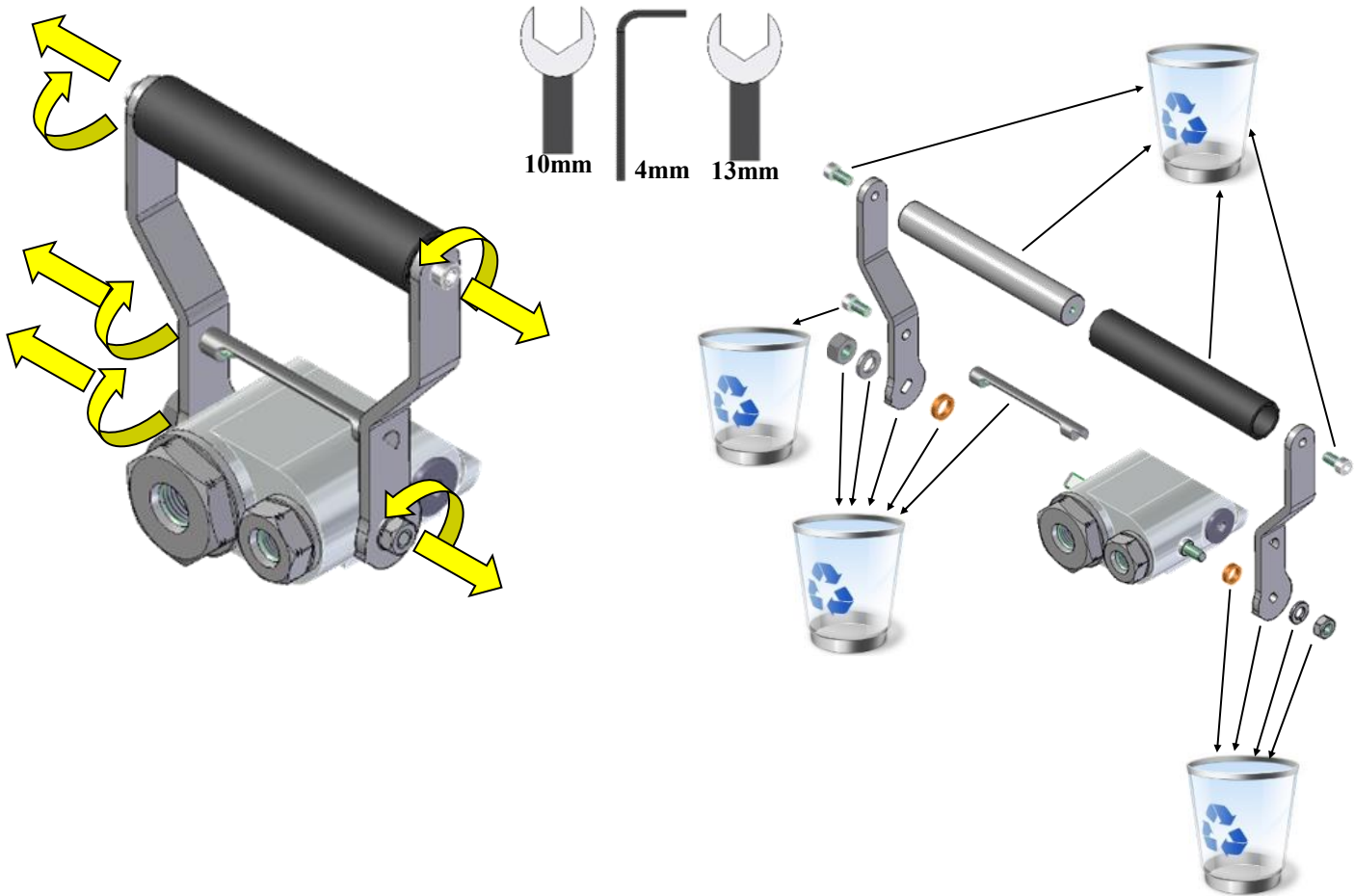

2. Inspect the fill valve for any damage.



**Check for excessive damage  
to body and stems.**

3. Prepare, align and assemble new handle components.

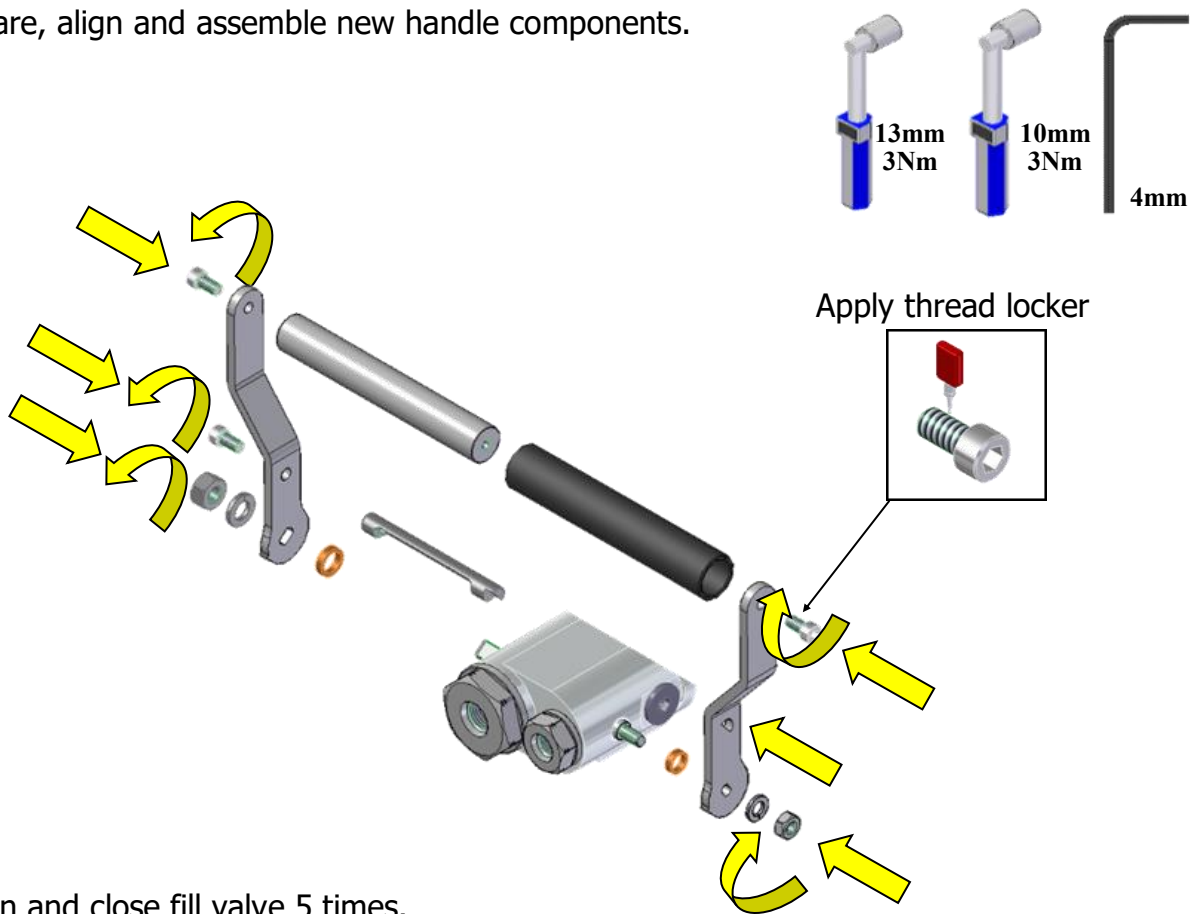

4. Open and close fill valve 5 times.

